



# Transform I-66

Fairfax Connector Route 699 Service

Board Transportation Committee Meeting  
October 2, 2018

Michael Felschow  
Fairfax County Department of Transportation

# Route 699 Overview

- Fairfax County was awarded a grant from Northern Virginia Transportation Commission (NVTC) for implementation of express bus service (Route 699) along I-66 using the managed high occupancy toll (HOT) lanes inside the Beltway.
- Service funded with I-66 inside the beltway toll revenue.
- The purpose of Route 699 is to reduce congestion within the I-66 corridor inside the Beltway.
- Funding covers operations and the purchase of 4 buses for the new service.
- Route 699 began service on December 4, 2017.
- The route operates on weekdays from the Government Center to Washington, D.C.
- The route consists of ten morning trips and ten afternoon trips.
- An express fare of \$4.25 is charged on the route.



**ROUTE 699**

**Government Center –  
Downtown D.C.**

**LEGEND**

- Route 699 —
- Timepoint ●
- Bus Stop ○

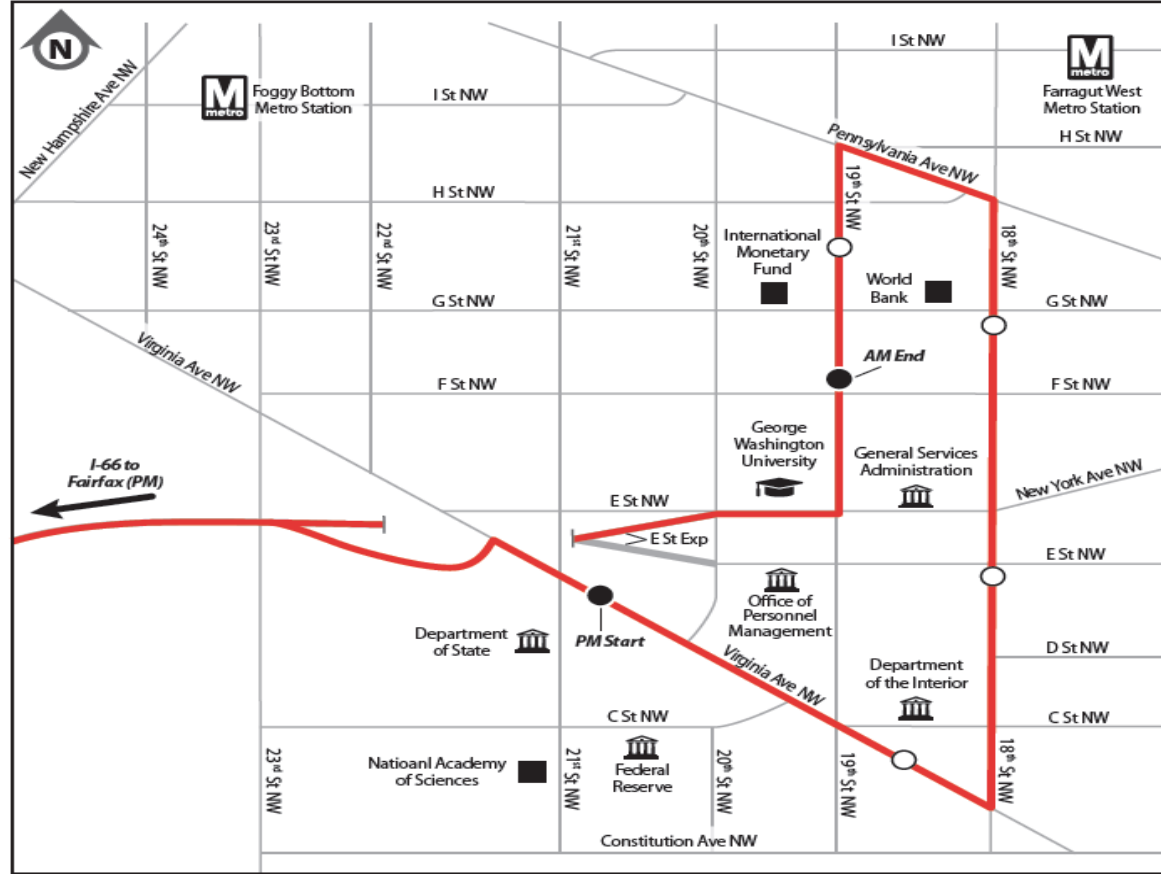
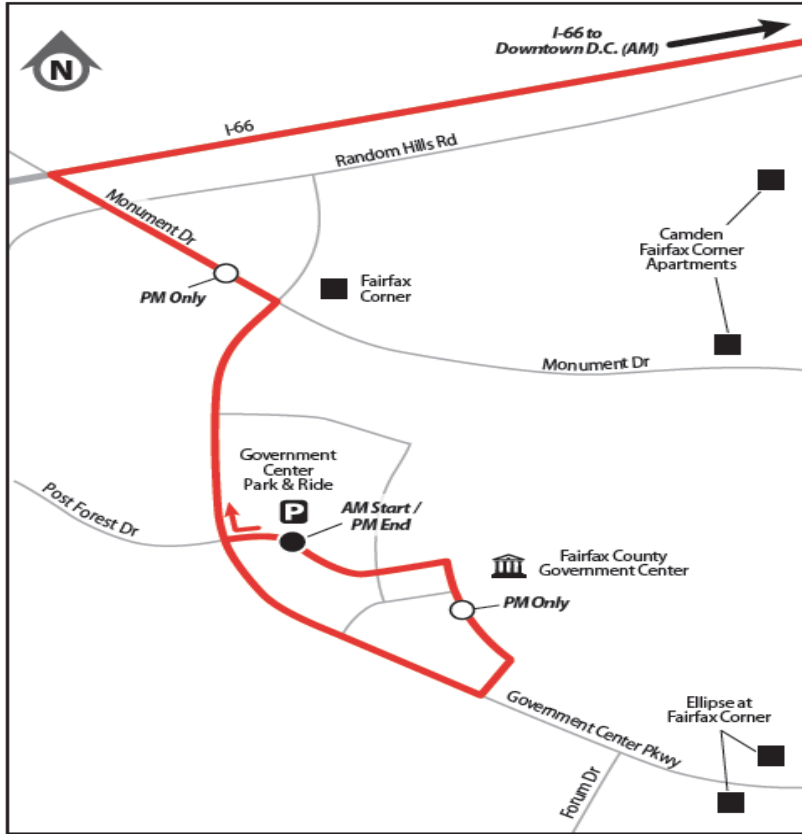

- Use exact fare; drivers do not carry change.
- Smoking, eating, drinking, and littering are strictly prohibited.

- Strollers must be folded.
- Use earphones with audio and video devices.

- Service animals are permitted on the bus. Other small animals are permitted only if transported in a closed pet carrier.

All Fairfax Connector buses are wheelchair accessible.

# Route 699 Performance

- From December 11, 2017, through September, 2018, the total preliminary ridership is approximately 58,300.
- The average weekday ridership for the first week of September was 542.
- At the end of January, the average weekday passengers per trip was 9.
- As of September, the average weekday passengers per trip is 27.



## ROUTE 699 AVERAGE WEEKDAY RIDERSHIP PER WEEK SINCE ROUTE INCEPTION (12/11/17 - 09/14/18)

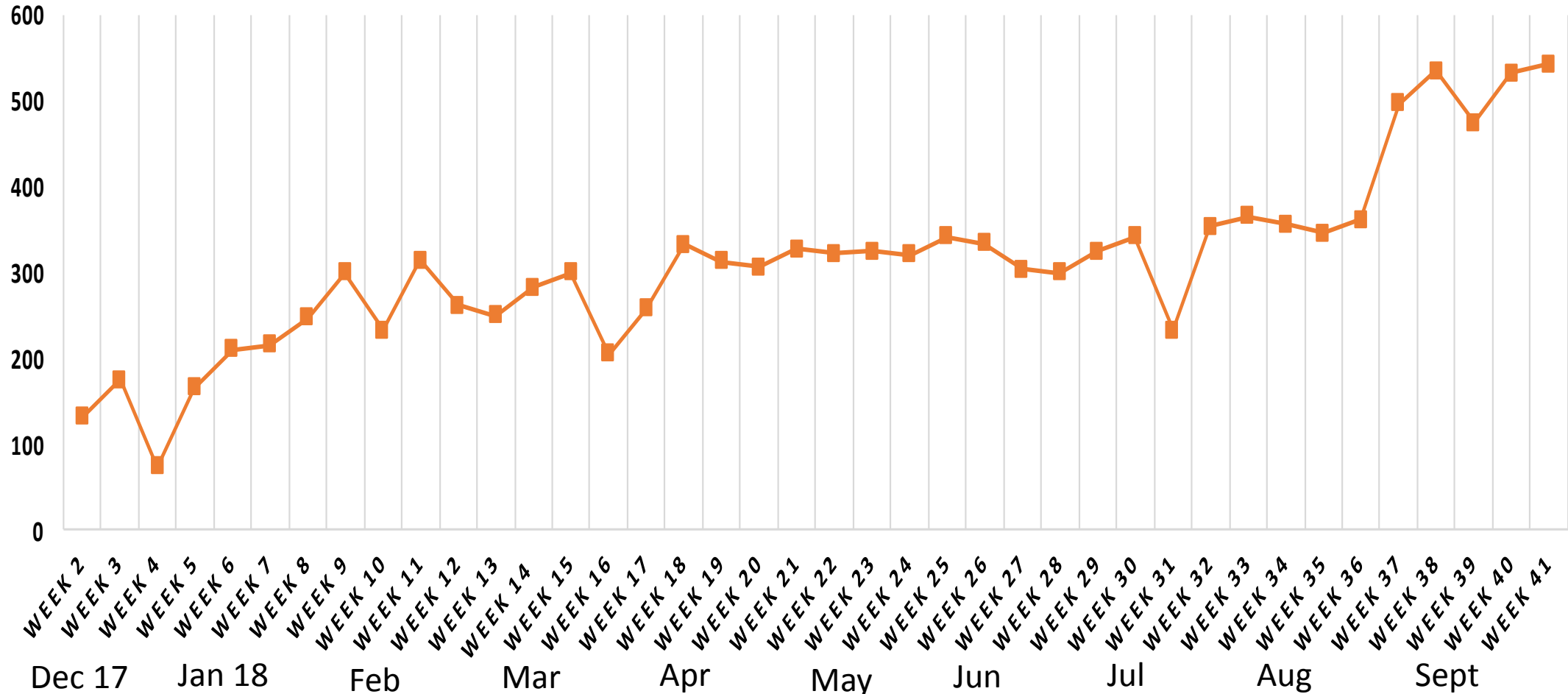

— Average weekday ridership is based on the total ridership per week divided by the total number of service days during that same week.

“I wholeheartedly love the idea of the new connector route from Government Center to Washington, DC.”

“This bus has changed my life. It’s given me hours back each day to spend with family, exercise, volunteer—anything but sitting on the metro or in traffic. My husband thanks you because I’m home sooner, my friends thank because they see me more, my colleagues at work thank you because I show up in a fabulous mood and my dog thanks you for more walks.”

I am a regular user of 699, and I support making the new stops permanent. These stops bring me 2 blocks closer to my destination of Farragut West metro stop.



# Public Outreach

- *Quantifiable reach to-date:*  
*Approximately 10M impressions*
  - Free ride week promotion.
  - Direct-to-customer outreach (employers, commuters).
  - Partner organization engagement (Go DC Go).
  - Traditional and social media engagement.
  - In-and out-of-home advertising.

**NEW FAIRFAX CONNECTOR EXPRESS BUS SERVICE**  
FAIRFAX COUNTY GOVERNMENT CENTER to DOWNTOWN D.C.

STRESS FREE TO D.C.

**699**  
IN  
**66**

 **Ride Route 699 for FREE December 4-8!**  
Full route information is available at [fairfaxconnector.com](https://www.fairfaxconnector.com)

## I-66 UTILIZATION AND 600 SERIES ROUTES AVERAGE WEEKDAY RIDERSHIP FROM DEC. 2016 TO AUG. 2018 - SOURCE GFI REPORTS

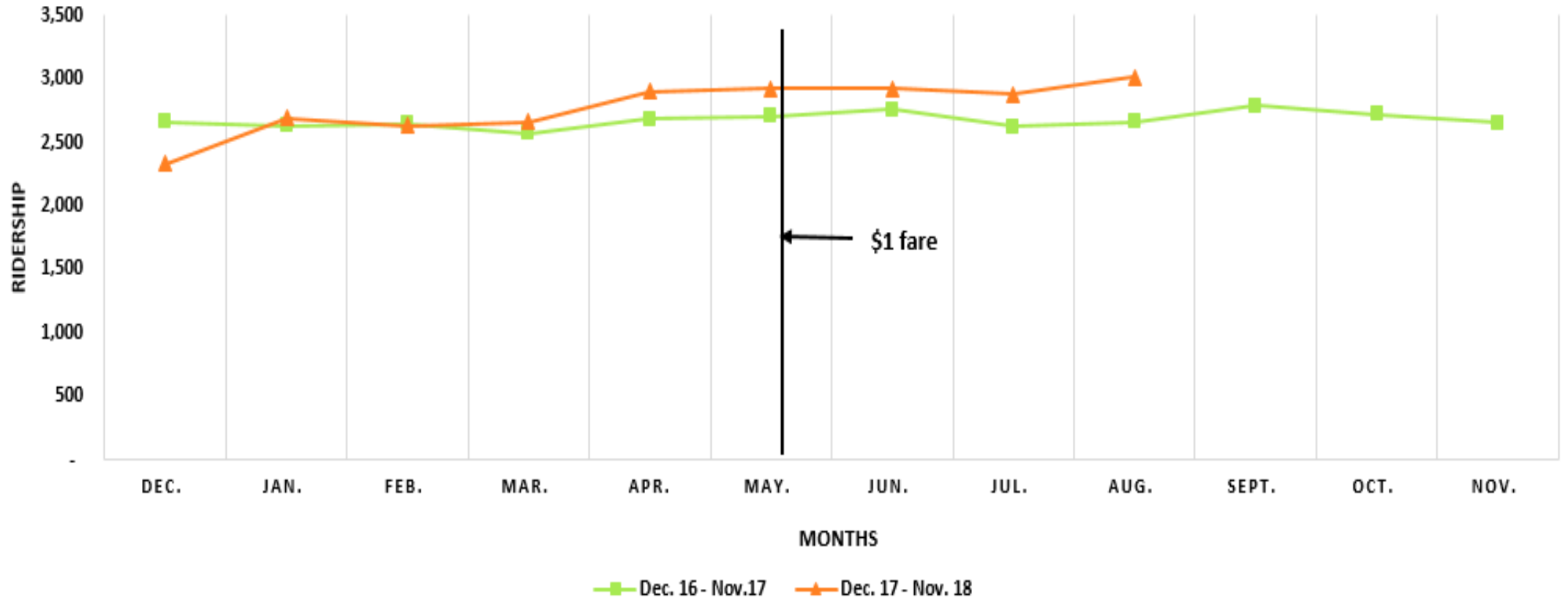

- In comparison to August 2017, ridership increased by 13.3% in August 2018.
- Conclusion: Route 699 has not negatively affected feeder service to Vienna Metrorail Station.



- Government Center Park & Ride Lot usage based on weekly counts:
  - June 2017: average of 43 vehicles.
  - August 2018: average of 232 vehicles.

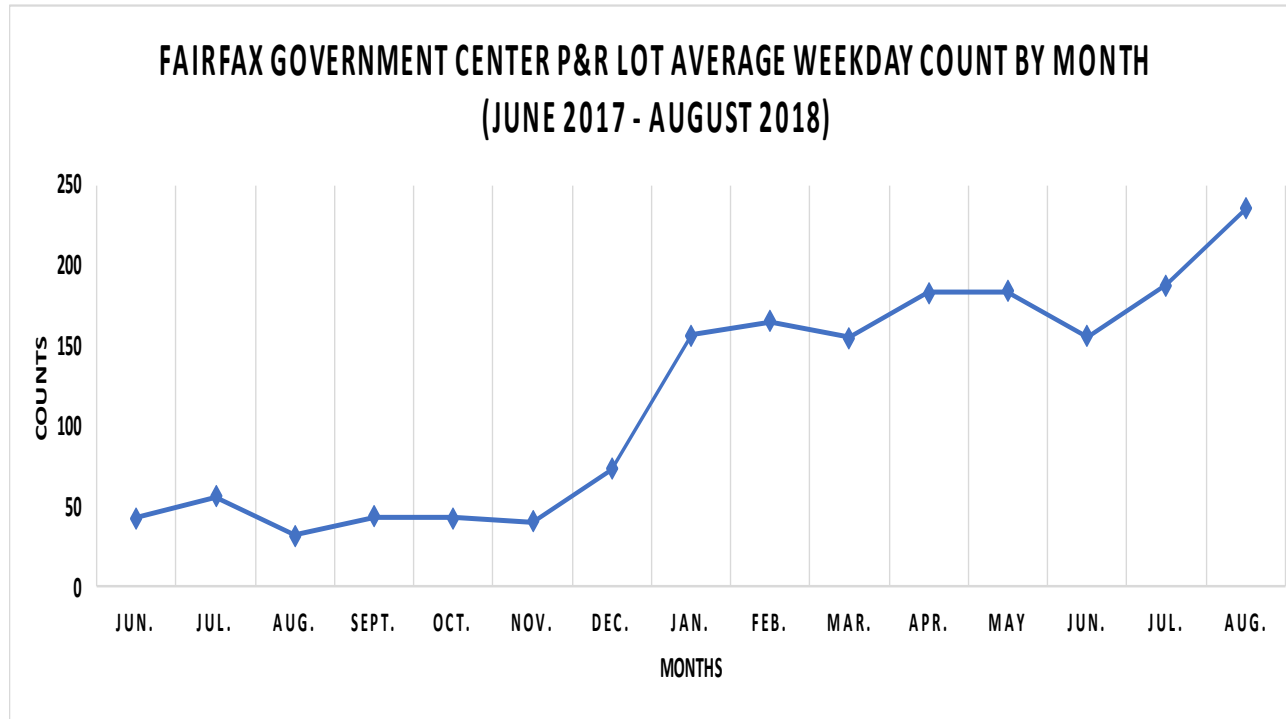

# Future Route 698

- New route serving the Pentagon.
- Express bus route featuring ten inbound morning trips and ten outbound afternoon trips operating during peak travel periods.
- Funding for the service is from tolls allocated through the multimodal grant program managed by NVTC as part of the I-66 Express Lanes Project inside the Beltway.
- Service will operate with 4 buses.
- Service is anticipated to begin January 2019.

Service Information	
Span of Service (A.M.)	5:30 to 8:00
Span of Service (P.M.)	3:00 to 6:00
Daily Trips	20
Headways (min)	15
Run Time (min)	33
Deadhead (min)	40



# How is Ridership Before and After I-66 Tolling?

## Average Weekday Ridership of I-66 Corridor Railways

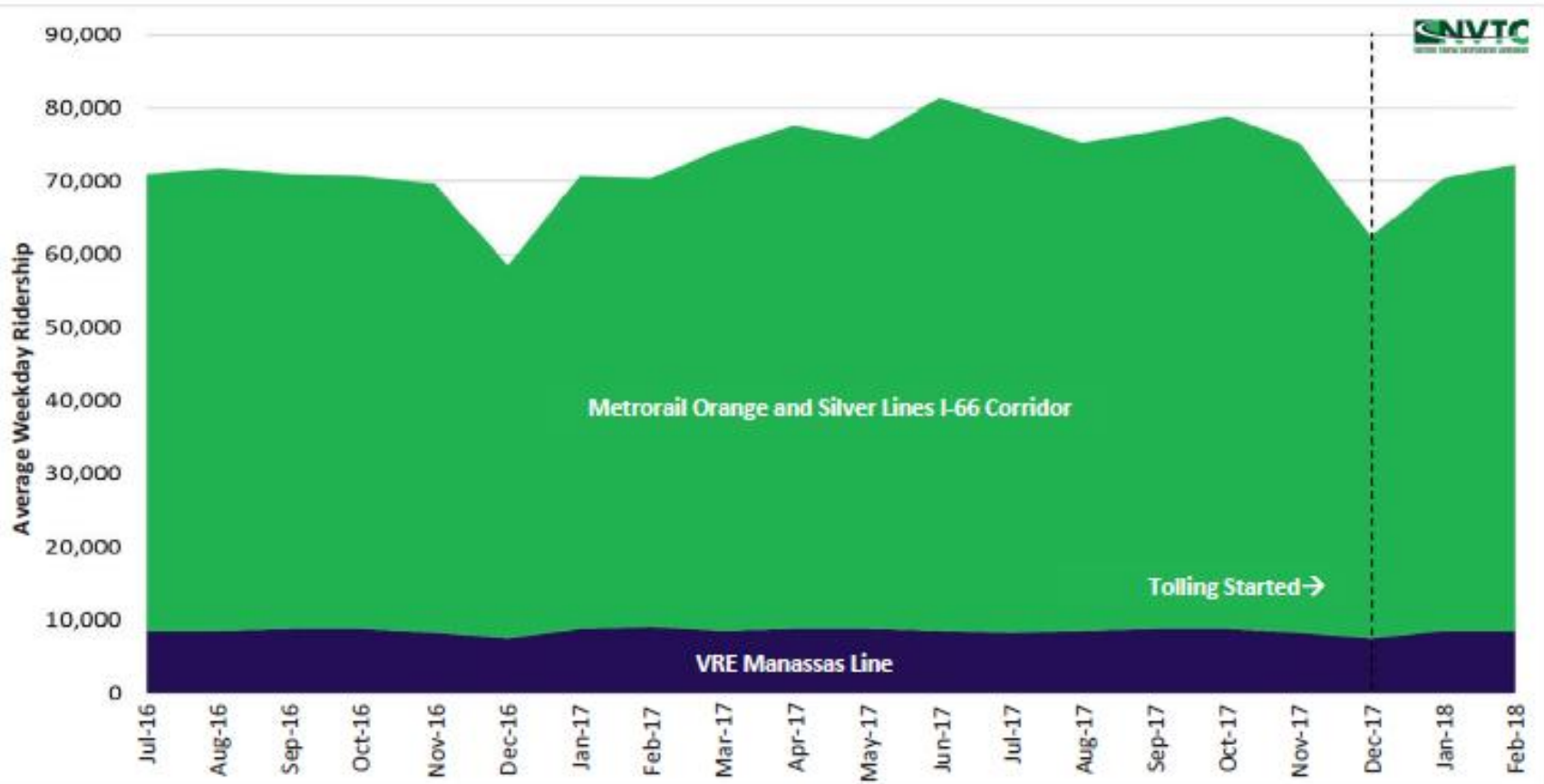

Note: Metrorail average weekday ridership of trips between Wiehle-Reston East, Spring Hill, Greensboro, Tysons Corner, McLean, Vienna, Dunn Loring, West Falls Church, and East Falls Church and all other stations. Ridership includes peak and non-peak periods.

Source: WMATA and VRE

**Figure 5: Average Weekday Ridership of I-66 Corridor (Express Buses)**

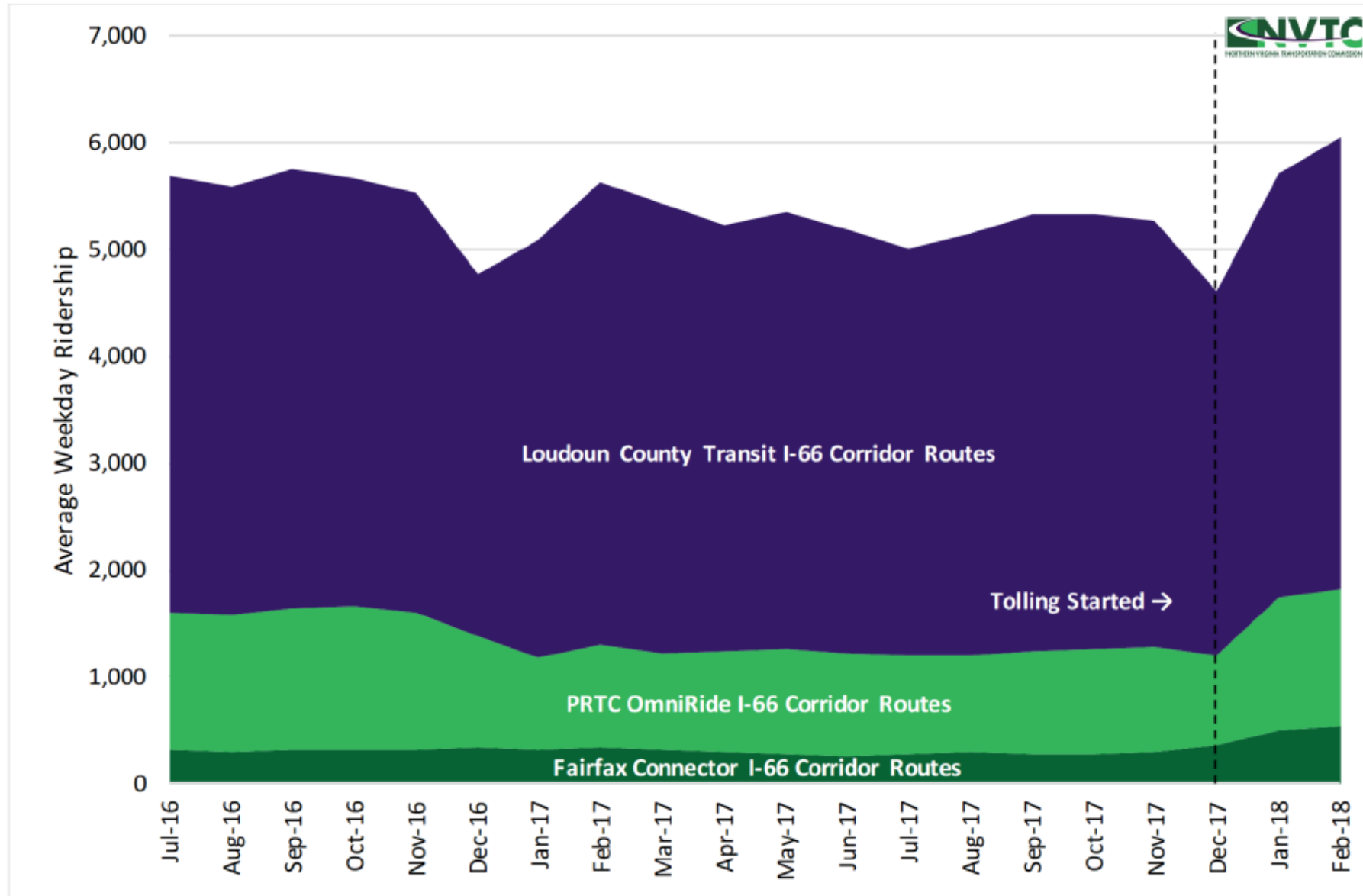

Note: Loudoun County Transit I-66 Corridor Routes: 101-111, 201-211, 251-253, 301-309, 401-420, 501-511, 601-612, 651-654, 701-708, 800D, and 801-822. PRTC OmniRide I-66 Corridor Routes: LH, G-100, G-200, M-100, and M-200. Fairfax Connector I-66 Corridor Routes: 599 and 699. These services extend peak periods only.

# Questions?